

PANEL OUTLIT (FRONT SIDE)

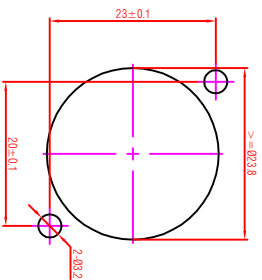

PCB LAYOUT (COMPONENT SIDE)

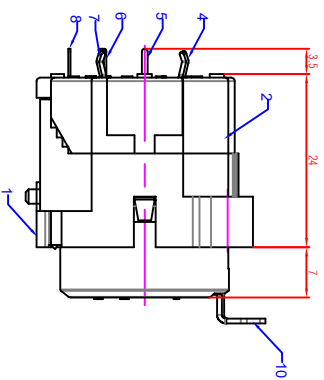
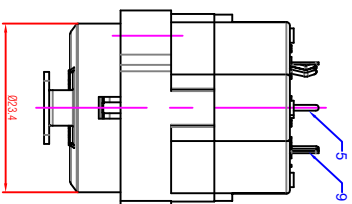
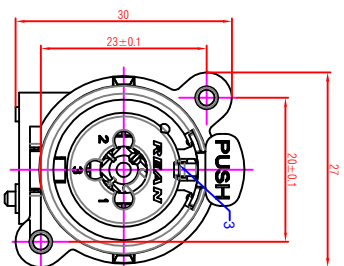
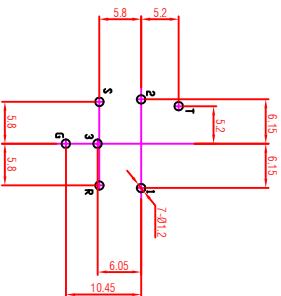

CONTACTS

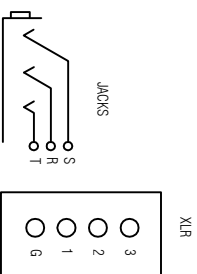

10	PUSH LATCH	STEEL, NICKEL PLATED
9	CONTACT (1)	PHOSPHOR BRONZE, NI+AU+Sn PLATED
8	GROUND CONTACT (G)	PHOSPHOR BRONZE, SILVER PLATED
7	CONTACT (S)	PHOSPHOR BRONZE, SILVER PLATED
6	CONTACT (R)	PHOSPHOR BRONZE, SILVER PLATED
5	CONTACT (2&3)	PHOSPHOR BRONZE, NI+AU+Sn PLATED
4	CONTACT (T)	PHOSPHOR BRONZE, SILVER PLATED
3	PUSH SPRING	STEEL, HEAT TREATMENT
2	COVER	PA6
1	HOUSING	PA6
NO	PART NAME	MATERIAL

Rev:	Revision Details	Date:	Year:	HEADQUARTERS IS THE PROPERTY OF KALINK NO PART THEREOF MAY BE REPRODUCED OR USED WITHOUT THE PERMISSION OF OWNER © 1976	
TITLE: RCJ6F-1V				Material:	Scale:
REXANT				2 : 1	2 : 1
Design: 2018.08.12				Checked: 2018.08.12	Approved: 2018.08.12
Design By: 1				Approved By: 1	Signature: 1
Drawing No: 1					